

MAHER
COMMERCIAL REAL ESTATE

"THE SUITES AT CONCORD"

3316 LEMONE INDUSTRIAL BLVD.

FLEXIBLE OFFICE SPACE. FAST.

FOR LEASE



SECURE EXECUTIVE
OFFICES
180-396 SQ. FT.
AVAILABLE

CONFERENCE ROOMS,
KITCHEN
& RECEPTION AREA
COMMON RESTROOMS

24 HOUR ACCESS

EASY ACCESS FROM
U.S. HWY 63

SOCIAL DISTANCING
AWARENESS IN
DESIGN

MONTHLY & LONG
TERM LEASES

ON SITE
MANAGEMENT

CALL JOHN HANCOCK
573-489-5201 CELL
JOHNHANCOCK33@GMAIL.COM
WWW.MAHERCRE.COM



AVAILABLE SUITES

FOR LEASE

CALL JOHN HANCOCK
 573-489-5201 CELL
 JOHNHANCOCK33@GMAIL.COM
 WWW.MAHERCRE.COM

AVAILABLE

AVAILABLE

AVAILABLE

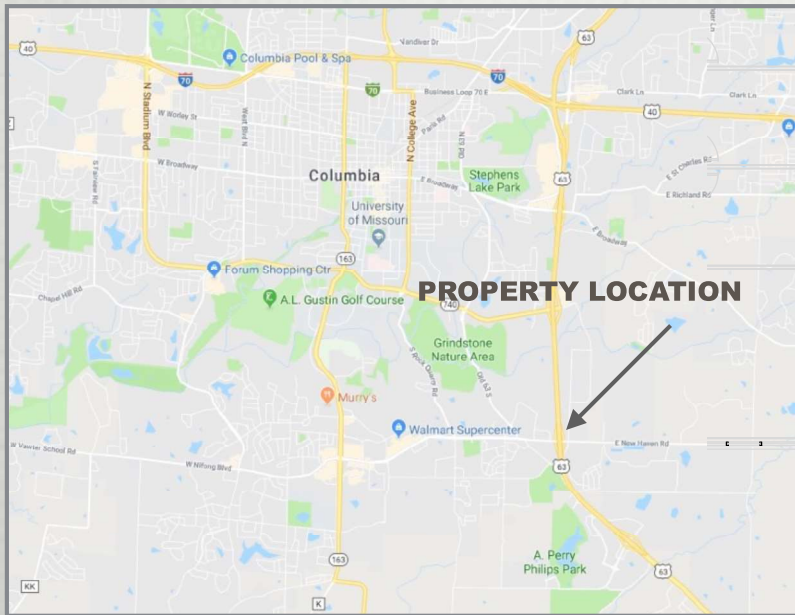

PROPERTY LOCATION

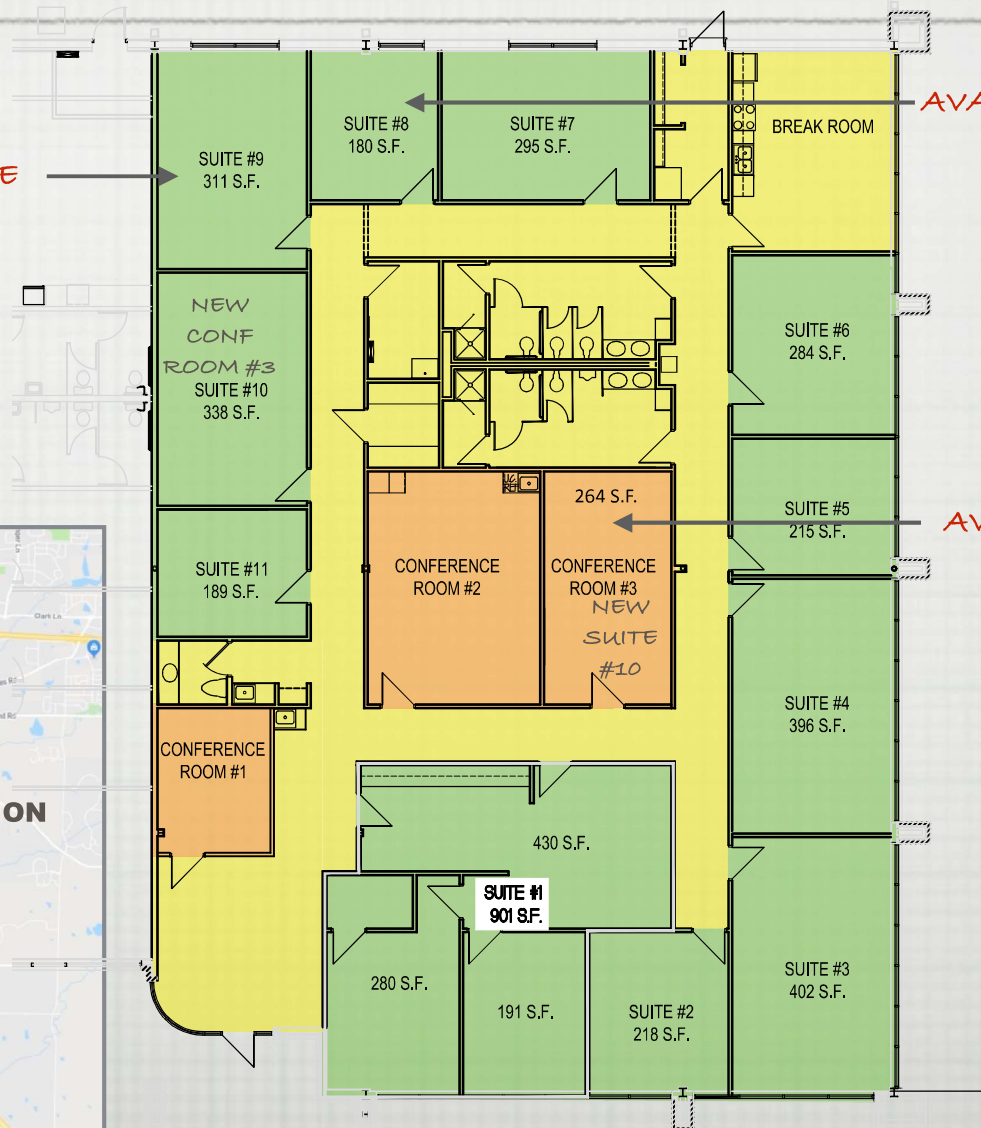

- 2,345 S.F.
- 840 S.F.
- 3,729 S.F.